

# BENITO

–Playground Equipment



## PROJECT

PROJ-014-2022

Surface: 370 m<sup>2</sup>

Email: [info@benito.com](mailto:info@benito.com)

Telephone: +34 93 852 1000

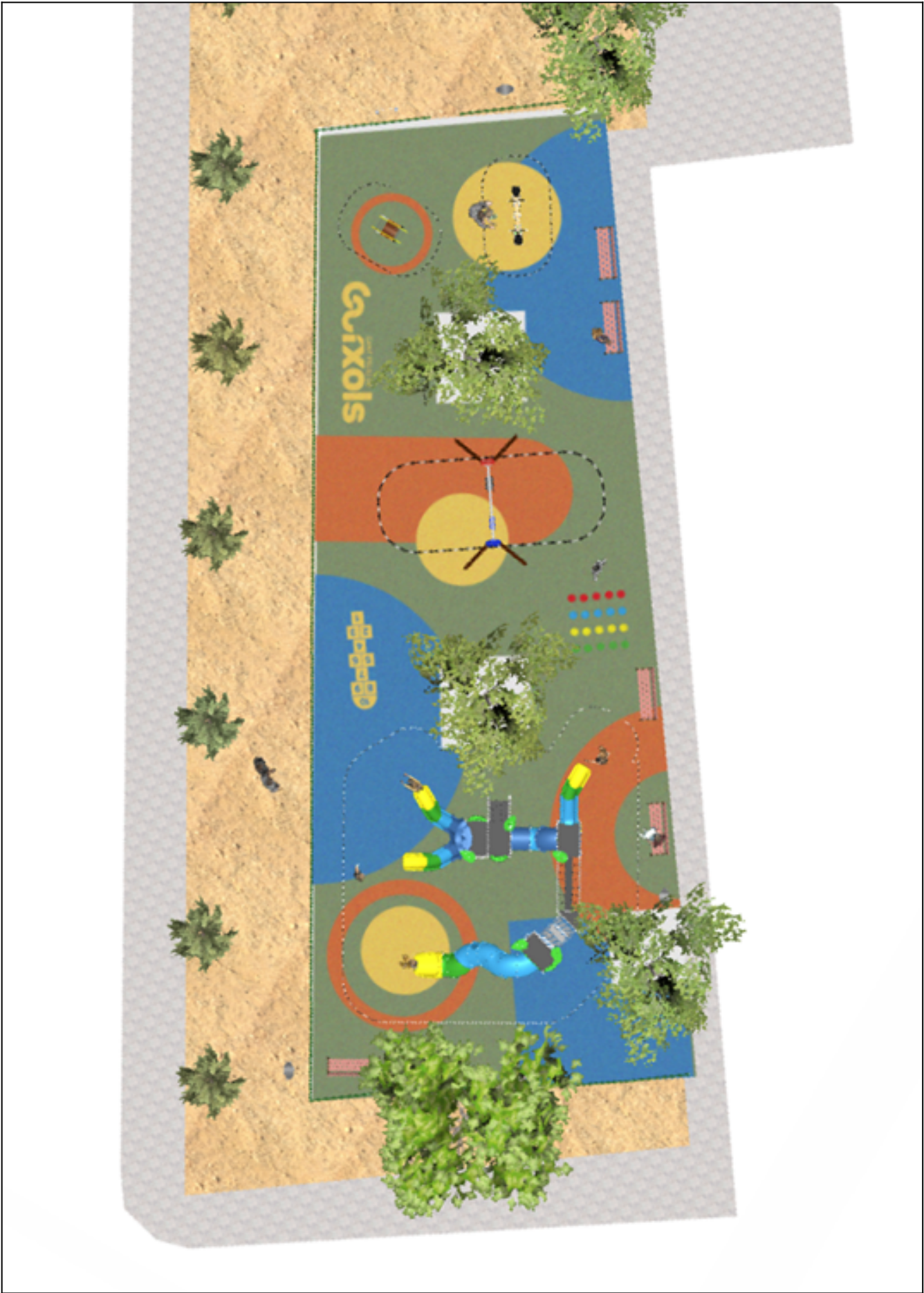



# BENITO

—Playground Equipment





# BENITO

-Playground Equipment





# BENITO

—Playground Equipment









# BENITO

-Playground Equipment



| Product  | Description  |
|--|--|
| JALU06<br>      | <b>Alu 6</b><br>The ALU collection <b>maximises playability</b> . Including lots of slides, bridges and dynamic elements, the ALU line encourages children to play, even those with disabilities. Its bright colours don't go unnoticed and the quality of materials guarantee high durability.<br><br><a href="#">Data Sheet</a> <a href="#">Acreditative Letter</a> <a href="#">Certificate Conformity</a> |
| JFS08D<br>      | <b>Maia</b><br>Fun and educative spring swing for children. Made of resistant materials according to the EN1176 standard.<br><br><a href="#">Data Sheet</a> <a href="#">Certificate</a> <a href="#">Certificate Conformity</a>   |
| JFS10<br>       | <b>Rider</b><br>Fun and educative spring swing for children. Made of resistant materials according to the EN1176 standard.<br><br><a href="#">Data Sheet</a> <a href="#">Certificate</a> <a href="#">Certificate Conformity</a>  |
| JL1011000<br> | <b>METAL 1 Plano 1 Cuna</b><br>Swings for children made of different materials such as wood and steel. Resistant to abrasion, corrosion and bad weather conditions.<br><br><a href="#">Data Sheet</a> <a href="#">Certificate</a> <a href="#">Certificate Conformity</a>   |